

Murphys Sanitary District 10 Year Capital Improvement Projects



August 2022

Murphys Sanitary District
15 Ernest Street, Suite A
Murphys, CA 95247

Prepared by:



Murphys Sanitary District

10-Year Capital Improvement Program

DRAFT

SEPTEMBER 2022

Prepared for:

MURPHYS SANITARY DISTRICT
15 Ernest Street, Suite A
Murphys, CA 95247
(209) 728-3094

Prepared by:

BLACK WATER CONSULTING ENGINEERS, INC.
602 Lyell Drive
Modesto, CA 95356
(209) 322-1820



TABLE OF CONTENTS

1 Capital Improvement Plan Project Overview 1
 2 Project Cost Estimates 2

LIST OF TABLES

Table 1 - 10-Year Capital Improvement Project List - Collection System Improvements 1
 Table 2 - 10-Year Capital Improvement Project List - Wastewater Treatment Plant Improvements..... 2
 Table 3 - Project 1: Sewer Line Replacement, MH 96-101 3
 Table 4 - Project 2: Sewer Line Replacement, MH 9-11, replace MH 204, add new MH between MH 203-204 4
 Table 5 - Project 3: Sewer Line Replacement, MH 64-65 and MH 76A-77 5
 Table 6 - Project 4: Sewer Line Replacement, MH 53-57-LP (Light Pole) 6
 Table 7 - Project 5: Sewer Line Replacement, MH 43-45 7
 Table 8 - Project 6: Sewer Line Replacement, MH 31-29 8
 Table 9 - Project 7: Sewer Line Replacement, MH 40-41 9
 Table 10 - Project 8: Add New Manhole Between MH 94-95..... 10
 Table 11 - Project 9: Sewer Line Replacement, MH 175-179 11
 Table 12 - Project 10: Clay Pipe Replacement, MH 18-17-14 MH 18 to clean out 12
 Table 13 - Project 11: Clay Pipe Replacement, MH 18 to clean out 13
 Table 14 - Project 12: Clay Pipe Replacement, MH 82-84 14
 Table 15 - Project 13: Clay Pipe Replacement, MH 49-50 15
 Table 16 - Project 14: Clay Pipe Replacement, MH 51-52 16
 Table 17 - Project 15: Clay Pipe Replacement, MH 35-29 17
 Table 18 - Project 16: Clay Pipe Replacement, MH 29-31 18
 Table 19 - Project 17: Clay Pipe Replacement, MH 131-136 19
 Table 20 - Project 18: Clay Pipe Replacement, MH 123-124, Add New MH..... 20
 Table 21 - Project 19: Clay Pipe Replacement, MH 103-105 21
 Table 22 - Project 20: Clay Pipe Replacement, MH 105-135 22
 Table 23 - Project 21: Clay Pipe Replacement, MH 172-23 23
 Table 24 - Project 22: Clay Pipe Replacement, MH 14 to LH 24
 Table 25 - Project 23: Clay Pipe Replacement, MH 14-10 25
 Table 26 - Project 24: Force Main Replacement..... 26
 Table 27 - Project 25: Biosolids Management ¹ 27
 Table 28 - Project 26: WWTP Upgrade - Part II ¹ 28

LIST OF FIGURES

10-Year CIP Key Map	29
Figure 1	30
Figure 2	31
Figure 3	32
Figure 4	33
Figure 5	34
Figure 6	35
Figure 7	36

1 Capital Improvement Plan Project Overview

Table 1 and **Table 2** provide an overview of the 10-year Capital Improvement Plan (CIP) projects for the Murphys Sanitary District (MSD) collection system and wastewater treatment plant improvements.

Table 1 - 10-Year Capital Improvement Project List - Collection System Improvements

Project No.	Description	Construction Year	Estimated Construction Cost, \$	Estimated Project Cost, \$
1	Sewer Line Replacement, MH 96-101	2023	724,681	978,320
2	Sewer Line Replacement, MH 9-11, replace MH 204, add new MH between MH 203-204	2024	163,031	220,092
3	Sewer Line Replacement, MH 64-65 76A-77	2026	235,347	317,718
4	Sewer Line Replacement, MH 53-57-LP	2027	333,989	450,885
5	Sewer Line Replacement, MH 43-45	2022	244,603	330,214
6	Sewer Line Replacement, MH 31-29	2022	67,495	91,119
7	Sewer Line Replacement, MH 40-41	2022	85,404	115,296
8	New Manhole Between MH 94-95	2022	79,711	107,609
9	Sewer Line Replacement, MH 175-179	2022	192,159	259,415
10	Clay Pipe Replacement, MH 18-17-14 MH 18 to clean out	2024	135,000	182,250
11	Clay Pipe Replacement, MH 18 to clean out	2022	25,000	33,750
12	Clay Pipe Replacement, MH 82-84	2023	110,700	149,445
13	Clay Pipe Replacement, MH 49-50	2024	90,000	121,500
14	Clay Pipe Replacement, MH 51-52	2026	55,500	74,925
15	Clay Pipe Replacement, MH 35-29	2022	285,600	385,560
16	Clay Pipe Replacement, MH 29-31	2022	48,825	65,914
17	Clay Pipe Replacement, MH 131-136	2022	25,625	34,594
18	Clay Pipe Replacement, MH 123-124 Add new MH	2023	101,750	137,363
19	Clay Pipe Replacement, MH 103-105	2024	28,000	37,800
20	Clay Pipe Replacement, MH 105-135	2026	151,200	204,120
21	Clay Pipe Replacement, MH 172-23	2027	25,900	34,965
22	Clay Pipe Replacement, MH 14 to LH	2027	118,800	160,380
23	Clay Pipe Replacement, MH 14-10	2027	25,900	34,965
		TOTAL:	3,354,220	4,528,197

Table 2 - 10-Year Capital Improvement Project List - Wastewater Treatment Plant Improvements

Project No.	Description	Construction Year	Estimated Construction Cost, \$	Estimated Project Cost, \$
24	Sewer Force Main Replacement	2025	2,075,812	2,802,346
25 ¹	Biosolids Management	2026	0	0
26 ¹	WWTP Upgrade - Part II	2027	0	0
		TOTAL:	2,075,812	2,802,346

* Notes

- 1 Project will be paid for with state funds through the Clean Water State Revolving Funds. Construction and project costs will be evaluated with the funding application.

2 Project Cost Estimates

Preliminary cost estimates have been prepared for each project in the CIP. These are “pre-design” level estimates that will be refined once design is complete. Costs of 15% are included for engineering design and administration (EDA) and CEQA. Costs of 10% are included for engineering services during construction and construction management (ESDC/CM). These costs may include work performed by a consultant and/or District staff and are shown for budgetary purposes. Since there is a limited amount of information available to craft the cost estimates, CIP contingencies of 10% have also been added to project costs based on the potential for project scopes to change or for the unit costs to be greater than originally anticipated. Since this is a 10-year CIP, the cost for projects undertaken in years 2-10 will be impacted by inflation. The costs presented in this CIP are based on Engineering News Record (ENR) San Francisco Construction Cost Index (CCI): 13,137 (03/2021).

The following tables on the following pages provide a detailed cost estimate for every project in the MSD 10-Year CIP.

See the attached figures for locations of the MSD 10-Year CIP Projects.

Table 3 - Project 1: Sewer Line Replacement, MH 96-101

Sewer Line Replacement, MH 96-101								Project 1
Project Description:	This project consists of the replacement and installation of approximately 2,415 linear feet of 8" diameter sewer pipeline and 6 manholes (see FIGURE 1).							
General Location:	Dam Road							
Existing Pipe Material:	Clay							
Project Priority:	Yes							
Construction Year:	23-24							
Expenditures	Budget	22-23	23-24	24-25	25-26	26-27	27-28	Total Budgeted
CON-Construction	\$724,681	\$0	\$724,681	\$0	\$0	\$0	\$0	\$724,681
CTGY-CIP Contingency (10%)	\$72,468	\$72,468	\$0	\$0	\$0	\$0	\$0	\$72,468
EDA-Eng/Design/Admin (15%)	\$108,702	\$108,702	\$0	\$0	\$0	\$0	\$0	\$108,702
ESDC/CM - Cons. Mgmt (10%)	\$72,468	\$72,468	\$0	\$0	\$0	\$0	\$0	\$72,468
Expenditure Totals:	\$978,319	\$253,638	\$724,681	\$0	\$0	\$0	\$0	\$978,319
Method of Funding:								
Prop 1 - Clean Water State Revolving Fund:	\$978,319							

Table 4 - Project 2: Sewer Line Replacement, MH 9-11, replace MH 204, add new MH between MH 203-204

Sewer Line Replacement, MH 9-11, replace MH 204, add new MH between MH 203-204								Project 2
Project Description:	This project consists of the replacement and installation of approximately 393 linear feet of 8" diameter sewer pipeline and 5 manholes. Manhole 204 will be replaced and a new manhole will be placed directly in between manholes 203 and 204 (see FIGURE 5 and FIGURE 6).							
General Location:	Behind DEA							
Existing Pipe Material:	Clay							
Project Priority:	Yes							
Construction Year:	24-25							
Expenditures	Budget	22-23	23-24	24-25	25-26	26-27	27-28	Total Budgeted
CON-Construction	\$163,031	\$0	\$0	\$163,031	\$0	\$0	\$0	\$163,031
CTGY-CIP Contingency (10%)	\$16,303	\$0	\$0	\$16,303	\$0	\$0	\$0	\$16,303
EDA-Eng/Design/Admin (15%)	\$24,455	\$0	\$0	\$24,455	\$0	\$0	\$0	\$24,455
ESDC/CM - Cons. Mgmt (10%)	\$16,303	\$0	\$0	\$16,303	\$0	\$0	\$0	\$16,303
Expenditure Totals:	\$220,092	\$0	\$0	\$220,092	\$0	\$0	\$0	\$220,092
Method of Funding:								
Prop 1 - Clean Water State Revolving Fund:	\$220,092							

Table 5 - Project 3: Sewer Line Replacement, MH 64-65 and MH 76A-77

Sewer Line Replacement, MH 64-65 and MH 76A-77								Project 3
Project Description:	This project consists of the replacement and installation of approximately 741 linear feet of 8" diameter sewer pipeline and only 3 manholes due to previous replacement of manhole 64 (see FIGURE 3).							
General Location:	Mitchler @ Diggins							
Existing Pipe Material:	Clay							
Project Priority:	Yes							
Construction Year:	26-27							
Expenditures	Budget	22-23	23-24	24-25	25-26	26-27	27-28	Total Budgeted
CON-Construction	\$235,347	\$0	\$0	\$0	\$0	\$235,347	\$0	\$0
CTGY-CIP Contingency (10%)	\$23,535	\$0	\$0	\$0	\$0	\$23,535	\$0	\$0
EDA-Eng/Design/Admin (15%)	\$35,302	\$0	\$0	\$0	\$0	\$35,302	\$0	\$0
EDA-Eng/Design/Admin (10%)	\$23,535	\$0	\$0	\$0	\$0	\$23,535	\$0	\$0
Expenditure Totals:	\$317,718	\$0	\$0	\$0	\$0	\$317,718	\$0	\$0
Method of Funding:								
Prop 1 - Clean Water State Revolving Fund:	\$317,718							

Table 6 - Project 4: Sewer Line Replacement, MH 53-57-LP (Light Pole)

Sewer Line Replacement, MH 53-57-LP (Light Pole)								Project 4
Project Description:	This project consists of the replacement and installation of approximately 1,021 linear feet of 8" diameter sewer pipeline and 5 manholes, beginning at the light pole located approximately 90 feet south west of manhole 57 (see FIGURE 4).							
General Location:	Allen Lane Red Store							
Existing Pipe Material:	Clay							
Project Priority:	Yes							
Construction Year:	27-28							
Expenditures	Budget	22-23	23-24	24-25	25-26	26-27	27-28	Total Budgeted
CON-Construction	\$333,989	\$0	\$0	\$0	\$0	\$0	\$333,989	\$0
CTGY-CIP Contingency (10%)	\$33,399	\$0	\$0	\$0	\$0	\$0	\$33,399	\$0
EDA-Eng/Design/Admin (15%)	\$50,098	\$0	\$0	\$0	\$0	\$0	\$50,098	\$0
EDA-Eng/Design/Admin (10%)	\$33,399	\$0	\$0	\$0	\$0	\$0	\$33,399	\$0
Expenditure Totals:	\$450,885	\$0	\$0	\$0	\$0	\$0	\$450,885	\$0
Method of Funding:								
Prop 1 - Clean Water State Revolving Fund:	\$450,885							

Table 7 - Project 5: Sewer Line Replacement, MH 43-45

Sewer Line Replacement, MH 43-45								Project 5
Project Description:	This project consists of the replacement and installation of approximately 775 linear feet of 8" diameter sewer pipeline and 3 manholes (see FIGURE 3).							
General Location:	Main Street							
Existing Pipe Material:								
Project Priority:	Yes							
Construction Year:	27-28							
Expenditures	Budget	22-23	23-24	24-25	25-26	26-27	27-28	Total Budgeted
CON-Construction	\$244,603	\$0	\$0	\$0	\$0	\$0	\$244,603	\$0
CTGY-CIP Contingency (10%)	\$24,460	\$0	\$0	\$0	\$0	\$0	\$24,460	\$0
EDA-Eng/Design/Admin (15%)	\$36,690	\$0	\$0	\$0	\$0	\$0	\$36,690	\$0
EDA-Eng/Design/Admin (10%)	\$24,460	\$0	\$0	\$0	\$0	\$0	\$24,460	\$0
Expenditure Totals:	\$330,214	\$0	\$0	\$0	\$0	\$0	\$330,214	\$0
Method of Funding:								
Prop 1 - Clean Water State Revolving Fund:	\$330,214							

Table 8 - Project 6: Sewer Line Replacement, MH 31-29

Sewer Line Replacement, MH 31-29								Project 6
Project Description:	This project consists of the replacement and installation of approximately 306 linear feet of 8" diameter sewer pipeline and 2 manholes (see FIGURE 7).							
General Location:	6 Mile Road @ Scott Street							
Existing Pipe Material:	Clay							
Project Priority:	Yes							
Construction Year:	22-23							
Expenditures	Budget	22-23	23-24	24-25	25-26	26-27	27-28	Total Budgeted
CON-Construction	\$67,495	\$67,495	\$0	\$0	\$0	\$0	\$0	\$67,495
CTGY-CIP Contingency (10%)	\$6,750	\$6,750	\$0	\$0	\$0	\$0	\$0	\$6,750
EDA-Eng/Design/Admin (15%)	\$10,124	\$10,124	\$0	\$0	\$0	\$0	\$0	\$10,124
EDA-Eng/Design/Admin (10%)	\$6,750	\$6,750	\$0	\$0	\$0	\$0	\$0	\$6,750
Expenditure Totals:	\$91,118	\$91,118	\$0	\$0	\$0	\$0	\$0	\$91,118
Method of Funding:								
Prop 1 - Clean Water State Revolving Fund:	\$91,118							

Table 9 - Project 7: Sewer Line Replacement, MH 40-41

Sewer Line Replacement, MH 40-41								Project 7
Project Description:	This project consists of the replacement and installation of approximately 105 linear feet of 8" diameter sewer pipeline and 2 manholes (see FIGURE 6).							
General Location:	Jones Street @ Main							
Existing Pipe Material:	???							
Project Priority:	Yes							
Construction Year:	26-27							
Expenditures	Budget	22-23	23-24	24-25	25-26	26-27	27-28	Total Budgeted
CON-Construction	\$85,404	\$0	\$0	\$0	\$0	\$85,404	\$0	\$0
CTGY-CIP Contingency (10%)	\$8,540	\$0	\$0	\$0	\$0	\$8,540	\$0	\$0
EDA-Eng/Design/Admin (15%)	\$12,811	\$0	\$0	\$0	\$0	\$12,811	\$0	\$0
EDA-Eng/Design/Admin (10%)	\$8,540	\$0	\$0	\$0	\$0	\$8,540	\$0	\$0
Expenditure Totals:	\$115,295	\$0	\$0	\$0	\$0	\$115,295	\$0	\$0
Method of Funding:								
Prop 1 - Clean Water State Revolving Fund:	\$115,295							

Table 10 - Project 8: Add New Manhole Between MH 94-95

Add New Manhole Between MH 94-95								Project 8
Project Description:	Additional manhole will be placed directly in between manhole 94 and 95 (see FIGURE 1).							
General Location:	Dam Road							
Existing Pipe Material:	Clay							
Project Priority:	Yes							
Construction Year:	22-23							
Expenditures	Budget	22-23	23-24	24-25	25-26	26-27	27-28	Total Budgeted
CON-Construction	\$79,711	\$79,711	\$0	\$0	\$0	\$0	\$0	\$79,711
CTGY-CIP Contingency (10%)	\$7,971	\$7,971	\$0	\$0	\$0	\$0	\$0	\$7,971
EDA-Eng/Design/Admin (15%)	\$11,957	\$11,957	\$0	\$0	\$0	\$0	\$0	\$11,957
EDA-Eng/Design/Admin (10%)	\$7,971	\$7,971	\$0	\$0	\$0	\$0	\$0	\$7,971
Expenditure Totals:	\$107,610	\$107,610	\$0	\$0	\$0	\$0	\$0	\$107,610
Method of Funding:								
Prop 1 - Clean Water State Revolving Fund:	\$107,610							

Table 11 - Project 9: Sewer Line Replacement, MH 175-179

Sewer Line Replacement, MH 175-179								Project 9
Project Description:	This project consists of the replacement and installation of approximately 478 linear feet of 8" diameter sewer pipeline and 4 manholes (see FIGURE 2, 3, and 6).							
General Location:	Church Street by pool							
Existing Pipe Material:	Clay							
Project Priority:	Yes							
Construction Year:	22-23							
Expenditures	Budget	22-23	23-24	24-25	25-26	26-27	27-28	Total Budgeted
CON-Construction	\$192,159	\$192,159	\$0	\$0	\$0	\$0	\$0	\$192,159
CTGY-CIP Contingency (10%)	\$19,216	\$19,216	\$0	\$0	\$0	\$0	\$0	\$19,216
EDA-Eng/Design/Admin (15%)	\$28,824	\$28,824	\$0	\$0	\$0	\$0	\$0	\$28,824
EDA-Eng/Design/Admin (10%)	\$19,216	\$19,216	\$0	\$0	\$0	\$0	\$0	\$19,216
Expenditure Totals:	\$259,415	\$259,415	\$0	\$0	\$0	\$0	\$0	\$259,415
Method of Funding:								
Prop 1 - Clean Water State Revolving Fund:	\$259,415							

Table 12 - Project 10: Clay Pipe Replacement, MH 18-17-14 MH 18 to clean out

Clay Pipe Replacement, MH 18-17-14 MH 18 to clean out								Project 10
Project Description:	This project consists of the replacement and installation of approximately 675 linear feet of 6" diameter sewer pipeline. (see FIGURE 6).							
General Location:	Main Street							
Existing Pipe Material:	Clay							
Project Priority:	Yes							
Construction Year:	24-25							
Expenditures	Budget	22-23	23-24	24-25	25-26	26-27	27-28	Total Budgeted
CON-Construction	\$135,000	\$0	\$0	\$135,000	\$0	\$0	\$0	\$135,000
CTGY-CIP Contingency (10%)	\$13,500	\$0	\$0	\$13,500	\$0	\$0	\$0	\$13,500
EDA-Eng/Design/Admin (15%)	\$20,250	\$0	\$0	\$20,250	\$0	\$0	\$0	\$20,250
EDA-Eng/Design/Admin (10%)	\$13,500	\$0	\$0	\$13,500	\$0	\$0	\$0	\$13,500
Expenditure Totals:	\$182,250	\$0	\$0	\$182,250	\$0	\$0	\$0	\$182,250
Method of Funding:								
Prop 1 - Clean Water State Revolving Fund:	\$182,250							

Table 13 - Project 11: Clay Pipe Replacement, MH 18 to clean out

Clay Pipe Replacement, MH 18 to clean out								Project 11
Project Description:	This project consists of the replacement and installation of approximately 125 linear feet of 6" diameter sewer pipeline (see FIGURE 6).							
General Location:	Sheep Ranch							
Existing Pipe Material:	Clay							
Project Priority:	Yes							
Construction Year:	22-23							
Expenditures	Budget	22-23	23-24	24-25	25-26	26-27	27-28	Total Budgeted
CON-Construction	\$25,000	\$25,000	\$0	\$0	\$0	\$0	\$0	\$25,000
CTGY-CIP Contingency (10%)	\$2,500	\$2,500	\$0	\$0	\$0	\$0	\$0	\$2,500
EDA-Eng/Design/Admin (15%)	\$3,750	\$3,750	\$0	\$0	\$0	\$0	\$0	\$3,750
EDA-Eng/Design/Admin (10%)	\$2,500	\$2,500	\$0	\$0	\$0	\$0	\$0	\$2,500
Expenditure Totals:	\$33,750	\$33,750	\$0	\$0	\$0	\$0	\$0	\$33,750
Method of Funding:								
Prop 1 - Clean Water State Revolving Fund:	\$33,750							

Table 14 - Project 12: Clay Pipe Replacement, MH 82-84

Clay Pipe Replacement, MH 82-84								Project 12
Project Description:	This project consists of the replacement and installation of approximately 540 linear feet of 8" diameter sewer pipeline (see FIGURE 3).							
General Location:	Tanner Court							
Existing Pipe Material:	Clay							
Project Priority:	Yes							
Construction Year:	23-24							
Expenditures	Budget	22-23	23-24	24-25	25-26	26-27	27-28	Total Budgeted
CON-Construction	\$110,700	\$0	\$110,700	\$0	\$0	\$0	\$0	\$110,700
CTGY-CIP Contingency (10%)	\$11,070	\$0	\$11,070	\$0	\$0	\$0	\$0	\$11,070
EDA-Eng/Design/Admin (15%)	\$16,605	\$0	\$16,605	\$0	\$0	\$0	\$0	\$16,605
EDA-Eng/Design/Admin (10%)	\$11,070	\$0	\$11,070	\$0	\$0	\$0	\$0	\$11,070
Expenditure Totals:	\$149,445	\$0	\$149,445	\$0	\$0	\$0	\$0	\$149,445
Method of Funding:								
Prop 1 - Clean Water State Revolving Fund:	\$149,445							

Table 15 - Project 13: Clay Pipe Replacement, MH 49-50

Clay Pipe Replacement, MH 49-50								Project 13
Project Description:	This project consists of the replacement and installation of approximately 450 linear feet of 6" diameter sewer pipeline (see FIGURE 4).							
General Location:	School Street							
Existing Pipe Material:	Clay							
Project Priority:	Yes							
Construction Year:	24-25							
Expenditures	Budget	22-23	23-24	24-25	25-26	26-27	27-28	Total Budgeted
CON-Construction	\$90,000	\$0	\$0	\$90,000	\$0	\$0	\$0	\$90,000
CTGY-CIP Contingency (10%)	\$9,000	\$0	\$0	\$9,000	\$0	\$0	\$0	\$9,000
EDA-Eng/Design/Admin (15%)	\$13,500	\$0	\$0	\$13,500	\$0	\$0	\$0	\$13,500
EDA-Eng/Design/Admin (10%)	\$9,000	\$0	\$0	\$9,000	\$0	\$0	\$0	\$9,000
Expenditure Totals:	\$121,500	\$0	\$0	\$121,500	\$0	\$0	\$0	\$121,500
Method of Funding:								
Prop 1 - Clean Water State Revolving Fund:	\$121,500							

Table 16 - Project 14: Clay Pipe Replacement, MH 51-52

Clay Pipe Replacement, MH 51-52								Project 14
Project Description:	This project consists of the replacement and installation of approximately 300 linear feet of 6" diameter sewer pipeline (see FIGURE 4).							
General Location:	Behind Chevron							
Existing Pipe Material:	Clay							
Project Priority:	Yes							
Construction Year:	26-27							
Expenditures	Budget	22-23	23-24	24-25	25-26	26-27	27-28	Total Budgeted
CON-Construction	\$55,500	\$0	\$0	\$0	\$0	\$55,500	\$0	\$0
CTGY-CIP Contingency (10%)	\$5,550	\$0	\$0	\$0	\$0	\$5,550	\$0	\$0
EDA-Eng/Design/Admin (15%)	\$8,325	\$0	\$0	\$0	\$0	\$8,325	\$0	\$0
EDA-Eng/Design/Admin (10%)	\$5,550	\$0	\$0	\$0	\$0	\$5,550	\$0	\$0
Expenditure Totals:	\$74,925	\$0	\$0	\$0	\$0	\$74,925	\$0	\$0
Method of Funding:								
Prop 1 - Clean Water State Revolving Fund:	\$74,925							

Table 17 - Project 15: Clay Pipe Replacement, MH 35-29

Clay Pipe Replacement, MH 35-29								Project 15
Project Description:	This project consists of the replacement and installation of approximately 2,040 linear feet of 6" diameter sewer pipeline (see FIGURE 7).							
General Location:	Six Mile, Davie & Bottomly Property							
Existing Pipe Material:	Clay							
Project Priority:	Yes							
Construction Year:	22-23							
Expenditures	Budget	22-23	23-24	24-25	25-26	26-27	27-28	Total Budgeted
CON-Construction	\$285,600	\$285,600	\$0	\$0	\$0	\$0	\$0	\$285,600
CTGY-CIP Contingency (10%)	\$28,560	\$28,560	\$0	\$0	\$0	\$0	\$0	\$28,560
EDA-Eng/Design/Admin (15%)	\$42,840	\$42,840	\$0	\$0	\$0	\$0	\$0	\$42,840
EDA-Eng/Design/Admin (10%)	\$28,560	\$28,560	\$0	\$0	\$0	\$0	\$0	\$28,560
Expenditure Totals:	\$385,560	\$385,560	\$0	\$0	\$0	\$0	\$0	\$385,560
Method of Funding:								
Prop 1 - Clean Water State Revolving Fund:	\$385,560							

Table 18 - Project 16: Clay Pipe Replacement, MH 29-31

Clay Pipe Replacement, MH 29-31								Project 16
Project Description:	This project consists of the replacement and installation of approximately 315 linear feet of 6" diameter sewer pipeline (see FIGURE 6).							
General Location:	6 Mile @ Algiers							
Existing Pipe Material:	Clay							
Project Priority:	Yes							
Construction Year:	22-23							
Expenditures	Budget	22-23	23-24	24-25	25-26	26-27	27-28	Total Budgeted
CON-Construction	\$48,825	\$48,825	\$0	\$0	\$0	\$0	\$0	\$48,825
CTGY-CIP Contingency (10%)	\$4,883	\$4,883	\$0	\$0	\$0	\$0	\$0	\$4,883
EDA-Eng/Design/Admin (15%)	\$7,324	\$7,324	\$0	\$0	\$0	\$0	\$0	\$7,324
EDA-Eng/Design/Admin (10%)	\$4,883	\$4,883	\$0	\$0	\$0	\$0	\$0	\$4,883
Expenditure Totals:	\$65,914	\$65,914	\$0	\$0	\$0	\$0	\$0	\$65,914
Method of Funding:								
Prop 1 - Clean Water State Revolving Fund:	\$65,914							

Table 19 - Project 17: Clay Pipe Replacement, MH 131-136

Clay Pipe Replacement, MH 131-136								Project 17
Project Description:	This project consists of the replacement and installation of approximately 125 linear feet of 6" diameter sewer pipeline (see FIGURE 2).							
General Location:	Williams Street							
Existing Pipe Material:	Clay							
Project Priority:	Yes							
Construction Year:	22-23							
Expenditures	Budget	22-23	23-24	24-25	25-26	26-27	27-28	Total Budgeted
CON-Construction	\$25,625	\$25,625	\$0	\$0	\$0	\$0	\$0	\$25,625
CTGY-CIP Contingency (10%)	\$2,563	\$2,563	\$0	\$0	\$0	\$0	\$0	\$2,563
EDA-Eng/Design/Admin (15%)	\$3,844	\$3,844	\$0	\$0	\$0	\$0	\$0	\$3,844
EDA-Eng/Design/Admin (10%)	\$2,563	\$2,563	\$0	\$0	\$0	\$0	\$0	\$2,563
Expenditure Totals:	\$34,594	\$34,594	\$0	\$0	\$0	\$0	\$0	\$34,594
Method of Funding:								
Prop 1 - Clean Water State Revolving Fund:	\$34,594							

Table 20 - Project 18: Clay Pipe Replacement, MH 123-124, Add New MH

Clay Pipe Replacement, MH 123-124, Add New MH								Project 18
Project Description:	This project consists of the replacement and installation of approximately 140 linear feet of 6" diameter sewer pipeline (see FIGURE 2).							
General Location:	Apple Blossom							
Existing Pipe Material:	Clay							
Project Priority:	Yes							
Construction Year:	23-24							
Expenditures	Budget	22-23	23-24	24-25	25-26	26-27	27-28	Total Budgeted
CON-Construction	\$101,750	\$0	\$101,750	\$0	\$0	\$0	\$0	\$101,750
CTGY-CIP Contingency (10%)	\$10,175	\$0	\$10,175	\$0	\$0	\$0	\$0	\$10,175
EDA-Eng/Design/Admin (15%)	\$15,263	\$0	\$15,263	\$0	\$0	\$0	\$0	\$15,263
EDA-Eng/Design/Admin (10%)	\$10,175	\$0	\$10,175	\$0	\$0	\$0	\$0	\$10,175
Expenditure Totals:	\$137,363	\$0	\$137,363	\$0	\$0	\$0	\$0	\$137,363
Method of Funding:								
Prop 1 - Clean Water State Revolving Fund:	\$137,363							

Table 21 - Project 19: Clay Pipe Replacement, MH 103-105

Clay Pipe Replacement, MH 103-105								Project 19
Project Description:	This project consists of the replacement and installation of approximately 550 linear feet of 6" diameter sewer pipeline (see FIGURE 2).							
General Location:	Apple Blossom							
Existing Pipe Material:	Clay							
Project Priority:	Yes							
Construction Year:	24-25							
Expenditures	Budget	22-23	23-24	24-25	25-26	26-27	27-28	Total Budgeted
CON-Construction	\$28,000	\$0	\$0	\$28,000	\$0	\$0	\$0	\$28,000
CTGY-CIP Contingency (10%)	\$2,800	\$0	\$0	\$2,800	\$0	\$0	\$0	\$2,800
EDA-Eng/Design/Admin (15%)	\$4,200	\$0	\$0	\$4,200	\$0	\$0	\$0	\$4,200
EDA-Eng/Design/Admin (10%)	\$2,800	\$0	\$0	\$2,800	\$0	\$0	\$0	\$2,800
Expenditure Totals:	\$37,800	\$0	\$0	\$37,800	\$0	\$0	\$0	\$37,800
Method of Funding:								
Prop 1 - Clean Water State Revolving Fund:	\$37,800							

Table 22 - Project 20: Clay Pipe Replacement, MH 105-135

Clay Pipe Replacement, MH 105-135								Project 20
Project Description:	This project consists of the replacement and installation of approximately 1,080 linear feet of 6" diameter sewer pipeline (see FIGURE 2).							
General Location:	Apple Blossom							
Existing Pipe Material:	Clay							
Project Priority:	Yes							
Construction Year:	26-27							
Expenditures	Budget	22-23	23-24	24-25	25-26	26-27	27-28	Total Budgeted
CON-Construction	\$151,200	\$0	\$0	\$0	\$0	\$151,200	\$0	\$0
CTGY-CIP Contingency (10%)	\$15,120	\$0	\$0	\$0	\$0	\$15,120	\$0	\$0
EDA-Eng/Design/Admin (15%)	\$22,680	\$0	\$0	\$0	\$0	\$22,680	\$0	\$0
EDA-Eng/Design/Admin (10%)	\$15,120	\$0	\$0	\$0	\$0	\$15,120	\$0	\$0
Expenditure Totals:	\$204,120	\$0	\$0	\$0	\$0	\$204,120	\$0	\$0
Method of Funding:								
Prop 1 - Clean Water State Revolving Fund:	\$204,120							

Table 23 - Project 21: Clay Pipe Replacement, MH 172-23

Clay Pipe Replacement, MH 172-23								Project 21
Project Description:	This project consists of the replacement and installation of approximately 140 linear feet of 6" diameter sewer pipeline (see FIGURE 6).							
General Location:	Main Street behind UPUD							
Existing Pipe Material:	Clay							
Project Priority:	Yes							
Construction Year:	26-27							
Expenditures	Budget	22-23	23-24	24-25	25-26	26-27	27-28	Total Budgeted
CON-Construction	\$25,900	\$0	\$0	\$0	\$0	\$25,900	\$0	\$0
CTGY-CIP Contingency (10%)	\$2,590	\$0	\$0	\$0	\$0	\$2,590	\$0	\$0
EDA-Eng/Design/Admin (15%)	\$3,885	\$0	\$0	\$0	\$0	\$3,885	\$0	\$0
EDA-Eng/Design/Admin (10%)	\$2,590	\$0	\$0	\$0	\$0	\$2,590	\$0	\$0
Expenditure Totals:	\$34,965	\$0	\$0	\$0	\$0	\$34,965	\$0	\$0
Method of Funding:								
Prop 1 - Clean Water State Revolving Fund:	\$34,965							

Table 24 - Project 22: Clay Pipe Replacement, MH 14 to LH

Clay Pipe Replacement, MH 14 to LH								Project 22
Project Description:	This project consists of the replacement and installation of approximately 660 linear feet of 4" diameter sewer pipeline, 2 manhole, and 1 sewer cleanout (see FIGURE 6).							
General Location:	Church Street @ Main							
Existing Pipe Material:	Clay							
Project Priority:	Yes							
Construction Year:	27-28							
Expenditures	Budget	22-23	23-24	24-25	25-26	26-27	27-28	Total Budgeted
CON-Construction	\$118,800	\$0	\$0	\$0	\$0	\$0	\$118,800	\$0
CTGY-CIP Contingency (10%)	\$11,880	\$0	\$0	\$0	\$0	\$0	\$11,880	\$0
EDA-Eng/Design/Admin (15%)	\$17,820	\$0	\$0	\$0	\$0	\$0	\$17,820	\$0
EDA-Eng/Design/Admin (10%)	\$11,880	\$0	\$0	\$0	\$0	\$0	\$11,880	\$0
Expenditure Totals:	\$160,380	\$0	\$0	\$0	\$0	\$0	\$160,380	\$0
Method of Funding:								
Prop 1 - Clean Water State Revolving Fund:	\$160,380							

Table 25 - Project 23: Clay Pipe Replacement, MH 14-10

Clay Pipe Replacement, MH 14-10								Project 23
Project Description:	This project consists of the replacement and installation of approximately 140 linear feet of 6" diameter sewer pipeline (see FIGURE 6).							
General Location:	Main Street @ Kramer							
Existing Pipe Material:	Clay							
Project Priority:	Yes							
Construction Year:	27-28							
Expenditures	Budget	22-23	23-24	24-25	25-26	26-27	27-28	Total Budgeted
CON-Construction	\$25,900	\$0	\$0	\$0	\$0	\$0	\$25,900	\$0
CTGY-CIP Contingency (10%)	\$2,590	\$0	\$0	\$0	\$0	\$0	\$2,590	\$0
EDA-Eng/Design/Admin (15%)	\$3,885	\$0	\$0	\$0	\$0	\$0	\$3,885	\$0
EDA-Eng/Design/Admin (10%)	\$2,590	\$0	\$0	\$0	\$0	\$0	\$2,590	\$0
Expenditure Totals:	\$34,965	\$0	\$0	\$0	\$0	\$0	\$34,965	\$0
Method of Funding:								
Prop 1 - Clean Water State Revolving Fund:	\$34,965							

Table 26 - Project 24: Force Main Replacement

Force Main Replacement		Project 24							
Project Description:	This project consists of the replacement and installation of approximately 6,400 linear feet of 8" diameter force main pipeline between the influent pump station (IPS) and wastewater treatment plant (WWTP) (see FIGURE 7).								
General Location:	IPS adjacent to Angels Creek to the WWTP								
Existing Pipe Material:									
Project Priority:	Yes								
Construction Year:	25-26								
Expenditures	Budget	22-23	23-24	24-25	25-26	26-27	27-28	Total Budgeted	
CON-Construction	\$2,075,812	\$0	\$0	\$0	\$2,075,812	\$0	\$0	\$2,075,812	
CTGY-CIP Contingency (10%)	\$207,581	\$0	\$0	\$207,581	\$0	\$0	\$0	\$207,581	
EDA-Eng/Design/Admin (15%)	\$311,372	\$0	\$0	\$311,372	\$0	\$0	\$0	\$311,372	
EDA-Eng/Design/Admin (10%)	\$207,581	\$0	\$0	\$207,581	\$0	\$0	\$0	\$207,581	
Expenditure Totals:	\$2,802,346	\$0	\$0	\$726,534	\$2,075,812	\$0	\$0	\$2,802,346	
Method of Funding:									
Prop 1 - Clean Water State Revolving Fund:	\$2,802,346								

Table 27 - Project 25: Biosolids Management ¹

Biosolids Management								Project 25
Project Description:	Improvements at the District's WWTP for management of the biosolids.							
General Location:	WWTP							
Existing Pipe Material:	N/A							
Project Priority:	Yes							
Construction Year:	26-27							
Expenditures	Budget	22-23	23-24	24-25	25-26	26-27	27-28	Total Budgeted
CON-Construction	\$0	\$0	\$0	\$0	\$0	\$0	\$0	\$0
CTGY-CIP Contingency (10%)	\$0	\$0	\$0	\$0	\$0	\$0	\$0	\$0
EDA-Eng/Design/Admin (15%)	\$0	\$0	\$0	\$0	\$0	\$0	\$0	\$0
EDA-Eng/Design/Admin (10%)	\$0	\$0	\$0	\$0	\$0	\$0	\$0	\$0
Expenditure Totals:	\$0	\$0	\$0	\$0	\$0	\$0	\$0	\$0
Method of Funding:								
Clean Water State Revolving Funds:	\$0							

Notes:

1. Project will be paid for with state funds through the Clean Water State Revolving Funds. Construction and project costs will be evaluated with the funding application.

Table 28 - Project 26: WWTP Upgrade - Part II ¹

WWTP Upgrade - Part II								Project 26
Project Description:	The proposed project will replace the sand filtration system of the District's WWTP, installing a back-up generator, installing fence around Pond 4, installing a fence around the WWTP, and various upgrades to improve operation and maintenance.							
General Location:	WWTP							
Existing Pipe Material:	N/A							
Project Priority:	Yes							
Construction Year:	26-27							
Expenditures	Budget	22-23	23-24	24-25	25-26	26-27	27-28	Total Budgeted
CON-Construction	\$0	\$0	\$0	\$0	\$0	\$0	\$0	\$0
CTGY-CIP Contingency (10%)	\$0	\$0	\$0	\$0	\$0	\$0	\$0	\$0
EDA-Eng/Design/Admin (15%)	\$0	\$0	\$0	\$0	\$0	\$0	\$0	\$0
EDA-Eng/Design/Admin (10%)	\$0	\$0	\$0	\$0	\$0	\$0	\$0	\$0
Expenditure Totals:	\$0	\$0	\$0	\$0	\$0	\$0	\$0	\$0
Method of Funding:								
Clean Water State Revolving Funds:	\$0							

Notes:

1. Project will be paid for with state funds through the Clean Water State Revolving Funds. Construction and project costs will be evaluated with the funding application.

\\22388\MSD\DISTRICT ENGINEER\CAD\1456_01_22A_2021\BROOKHURST\BROOKHURST_01_22A_2021.dwg (9/1/2022 10:02:07 AM) ANNY PATRICK SCOTT

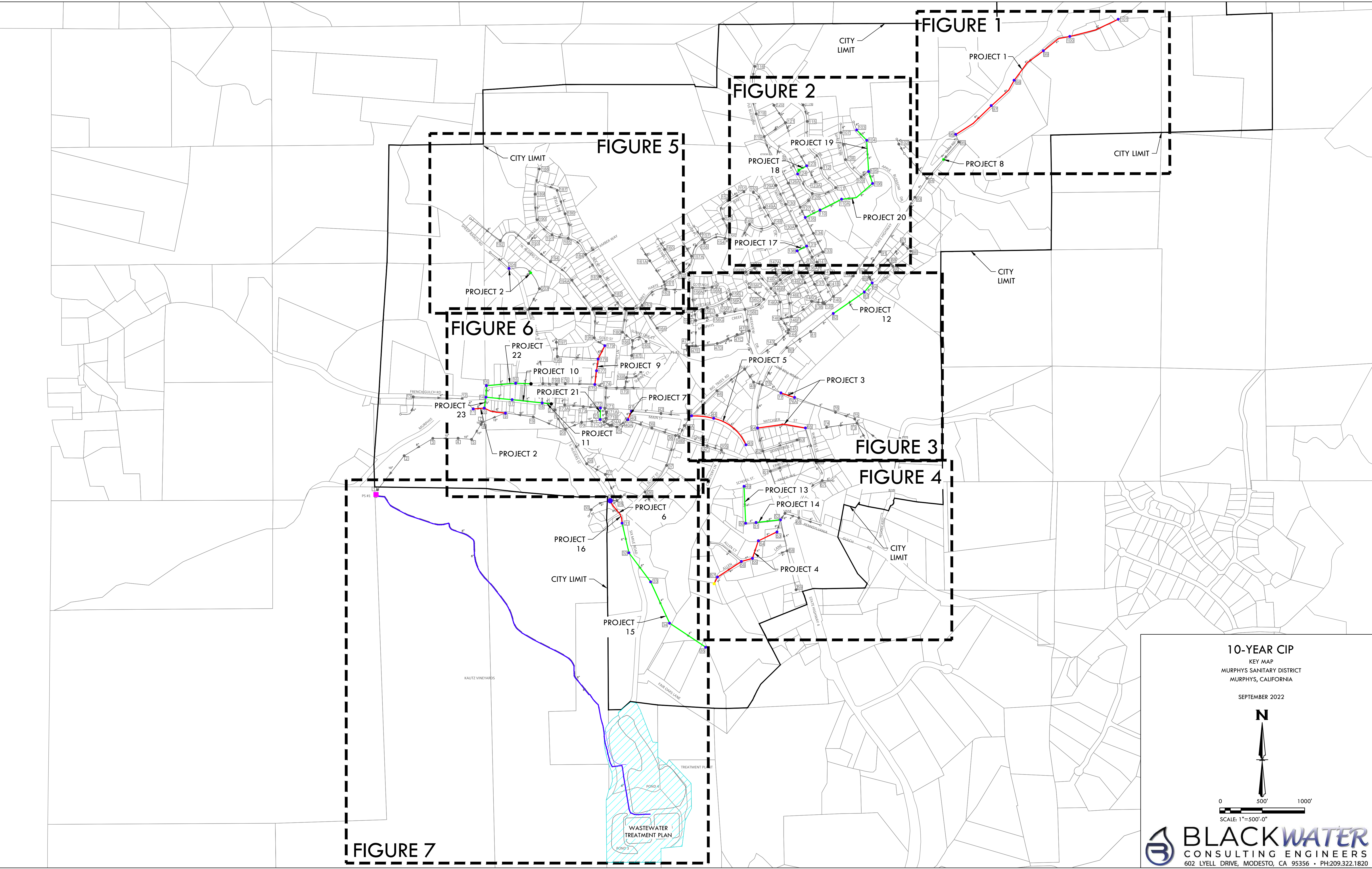

FIGURE 7

FIGURE 6

FIGURE 5

FIGURE 2

FIGURE 1

FIGURE 3

FIGURE 4

10-YEAR CIP
KEY MAP
MURPHYS SANITARY DISTRICT
MURPHYS, CALIFORNIA
SEPTEMBER 2022

N

0 500' 1000'

SCALE: 1"=500'-0"

BLACKWATER
CONSULTING ENGINEERS
602 LYELL DRIVE, MODESTO, CA 95356 • PH:209.322.1820

\\122388 ASD DISTRICT ENGINEER\CAD\TASK-01_22A_2021 BROCHURE\EXHIBITS\BROCHURES\888_10_YR_CIP\DWG PLOT_9/1/2022_10:01:14 AM BY PATRICK SCOTT

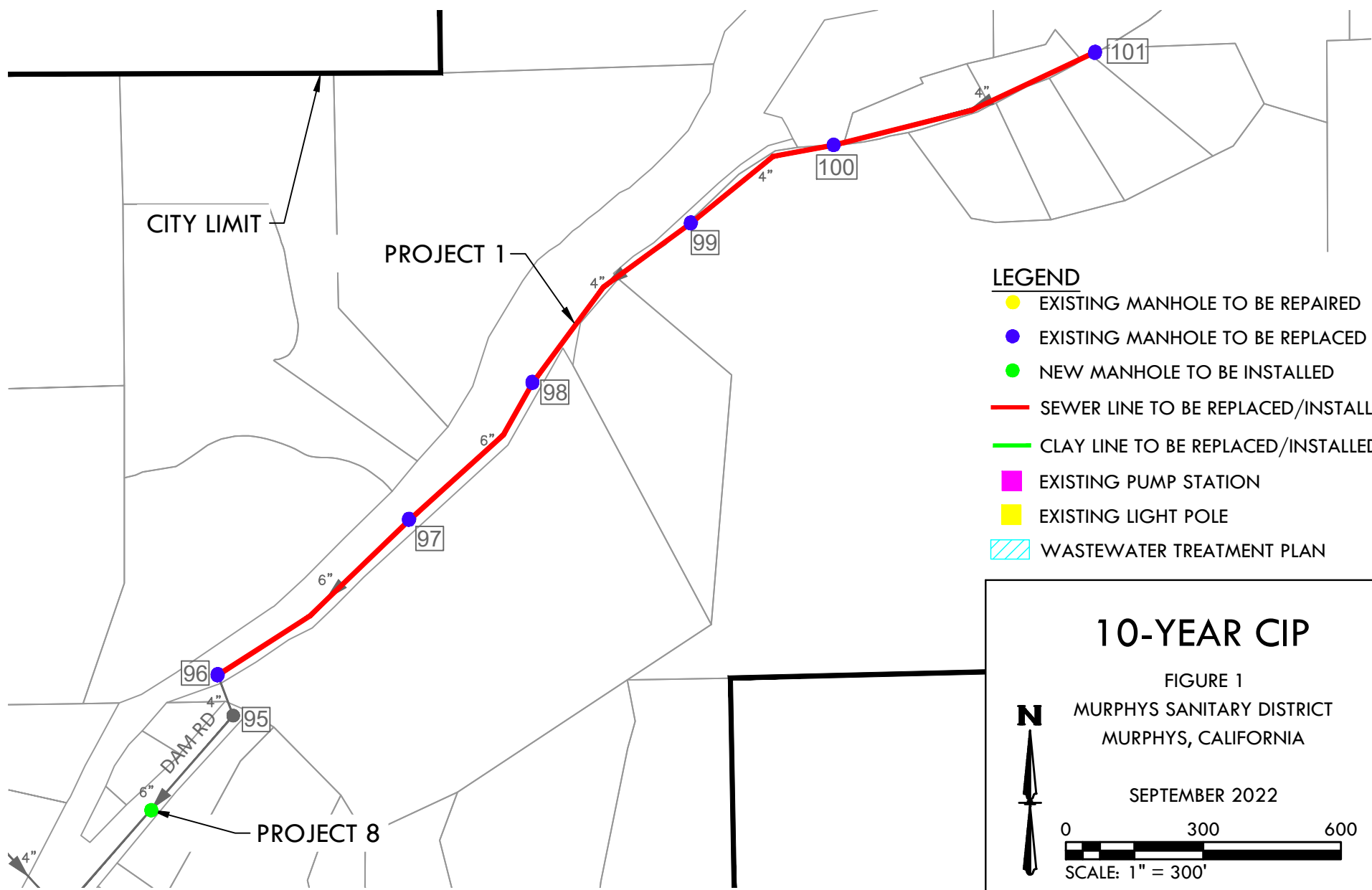

LEGEND

- EXISTING MANHOLE TO BE REPAIRED
- EXISTING MANHOLE TO BE REPLACED
- NEW MANHOLE TO BE INSTALLED
- SEWER LINE TO BE REPLACED/INSTALLED
- CLAY LINE TO BE REPLACED/INSTALLED
- EXISTING PUMP STATION
- EXISTING LIGHT POLE
- WASTEWATER TREATMENT PLAN

10-YEAR CIP

FIGURE 1
MURPHYS SANITARY DISTRICT
MURPHYS, CALIFORNIA

SEPTEMBER 2022

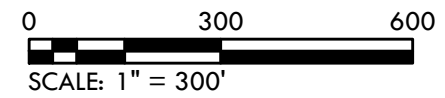

BLACKWATER
CONSULTING ENGINEERS
602 LYELL DRIVE, MODESTO, CA 95356 • PH:209.322.1820

4/22/2018 ASD DISTRICT ENGINEER(CAD)TASK-01_22A_2021 BROCHURE EXHIBIT(S) BROCHURES\888_10_YR_CIP.DWG PLOT: 9/1/2022 10:01:19 AM BY PATRICK SCOTT

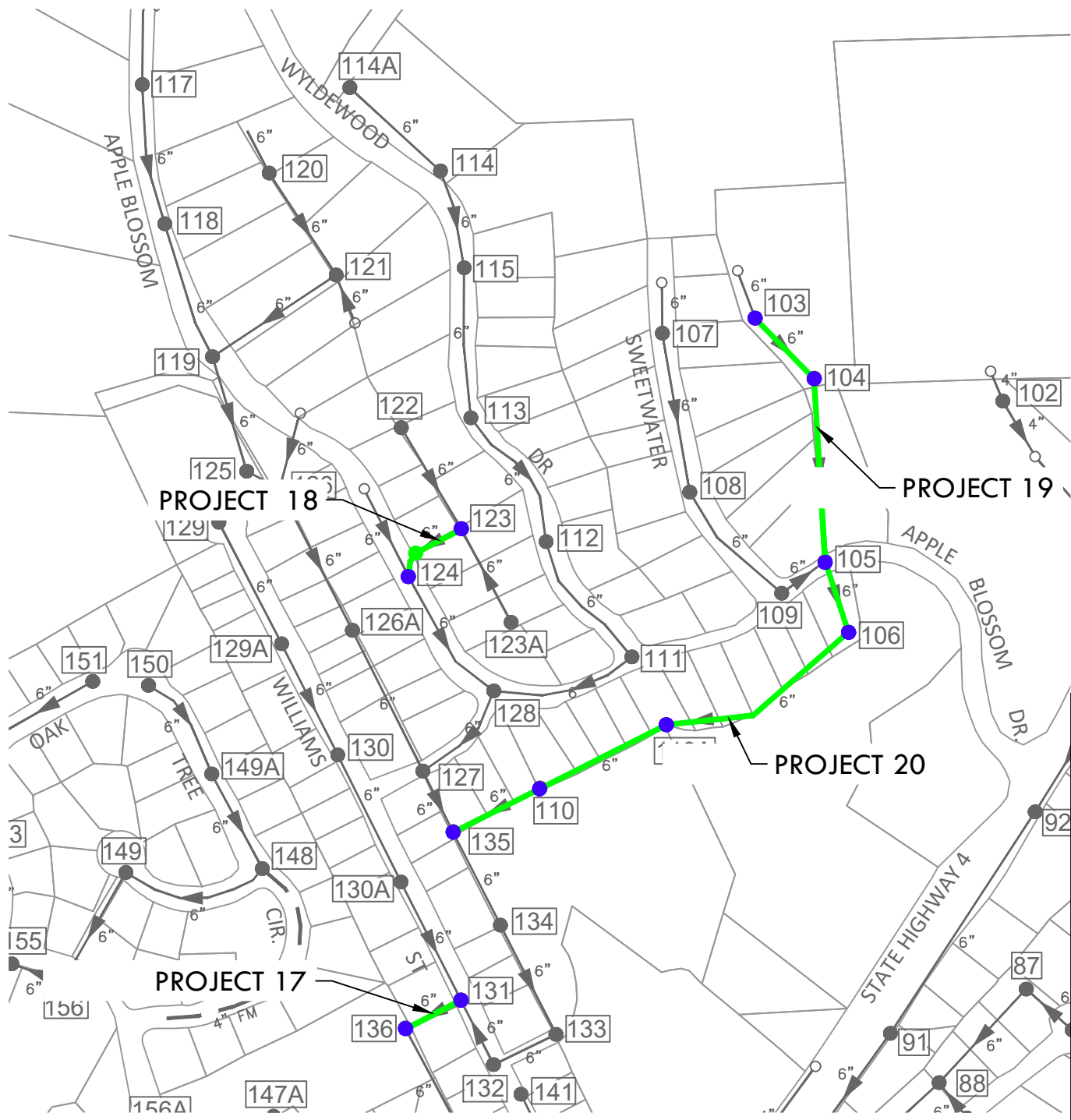

- LEGEND**
- EXISTING MANHOLE TO BE REPAIRED
 - EXISTING MANHOLE TO BE REPLACED
 - NEW MANHOLE TO BE INSTALLED
 - SEWER LINE TO BE REPLACED/INSTALLED
 - CLAY LINE TO BE REPLACED/INSTALLED
 - EXISTING PUMP STATION
 - EXISTING LIGHT POLE
 - WASTEWATER TREATMENT PLAN

10-YEAR CIP

FIGURE 2
MURPHYS SANITARY DISTRICT
MURPHYS, CALIFORNIA

SEPTEMBER 2022

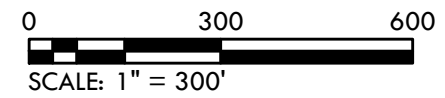

BLACKWATER
CONSULTING ENGINEERS
602 LYELL DRIVE, MODESTO, CA 95356 • PH:209.322.1820

\\122388 ASD DISTRICT ENGINEER\CAD\TASK-01_22A_2021 BROCHURE\EXHIBITS\BROCHURES\888_10_YR_CIP\DWG PLOT_9/1/2022 10:01:24 AM BY PATRICK SCOTT

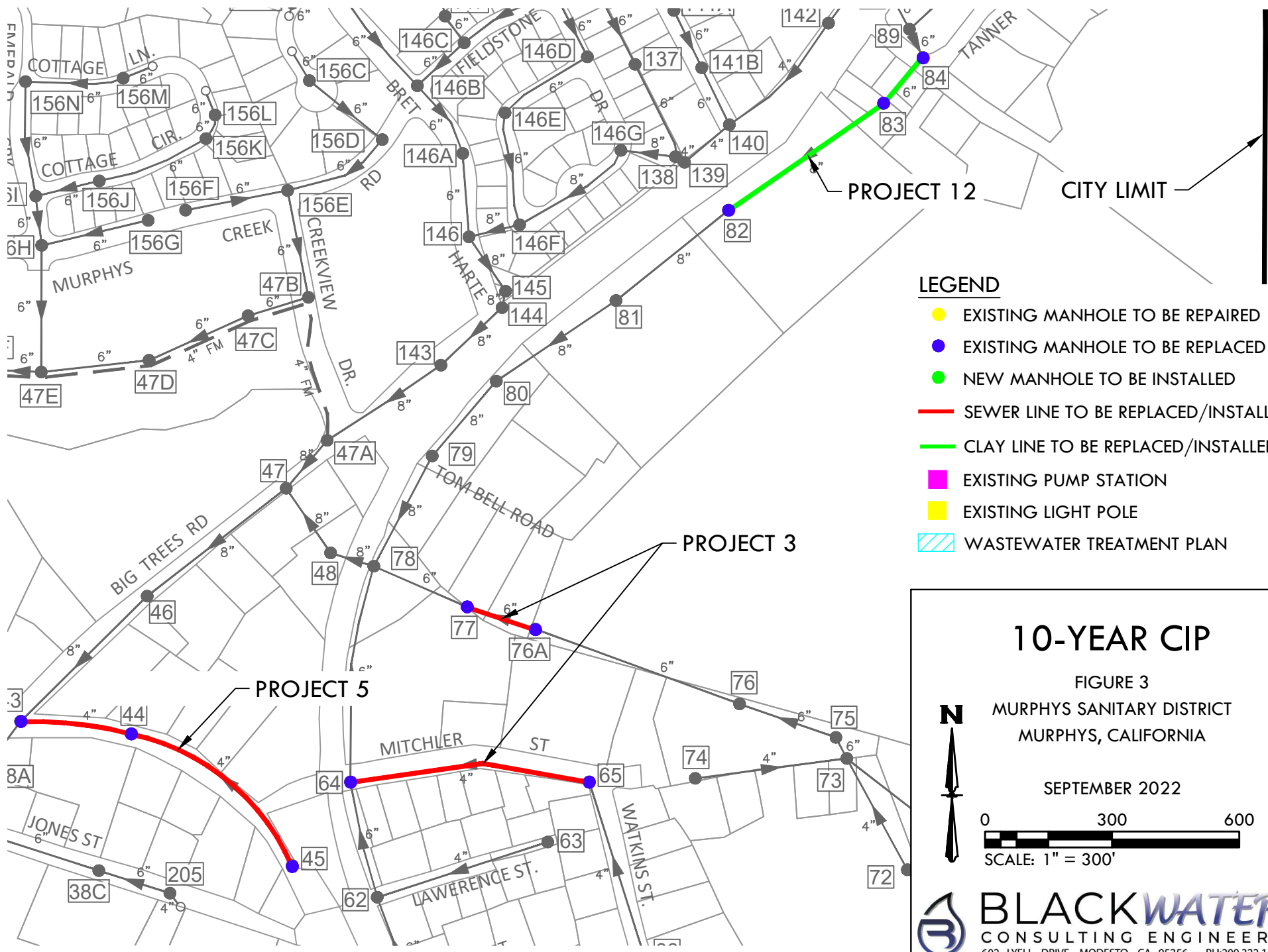

- LEGEND**
- EXISTING MANHOLE TO BE REPAIRED
 - EXISTING MANHOLE TO BE REPLACED
 - NEW MANHOLE TO BE INSTALLED
 - SEWER LINE TO BE REPLACED/INSTALLED
 - CLAY LINE TO BE REPLACED/INSTALLED
 - EXISTING PUMP STATION
 - EXISTING LIGHT POLE
 - WASTEWATER TREATMENT PLAN

10-YEAR CIP

FIGURE 3
MURPHYS SANITARY DISTRICT
MURPHYS, CALIFORNIA

SEPTEMBER 2022

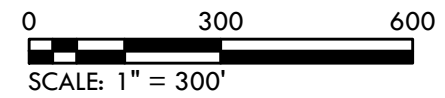

BLACKWATER
CONSULTING ENGINEERS
602 LYELL DRIVE, MODESTO, CA 95356 • PH:209.322.1820

\\122388 ASD DISTRICT ENGINEER\CAD\TASK_01_22A_2021 BROCHURE\EXHIBITS\BROCHURES\888_10_YR_CIP\DWG PLOT_9/1/2022 10:01:29 AM BY PATRICK SCOTT

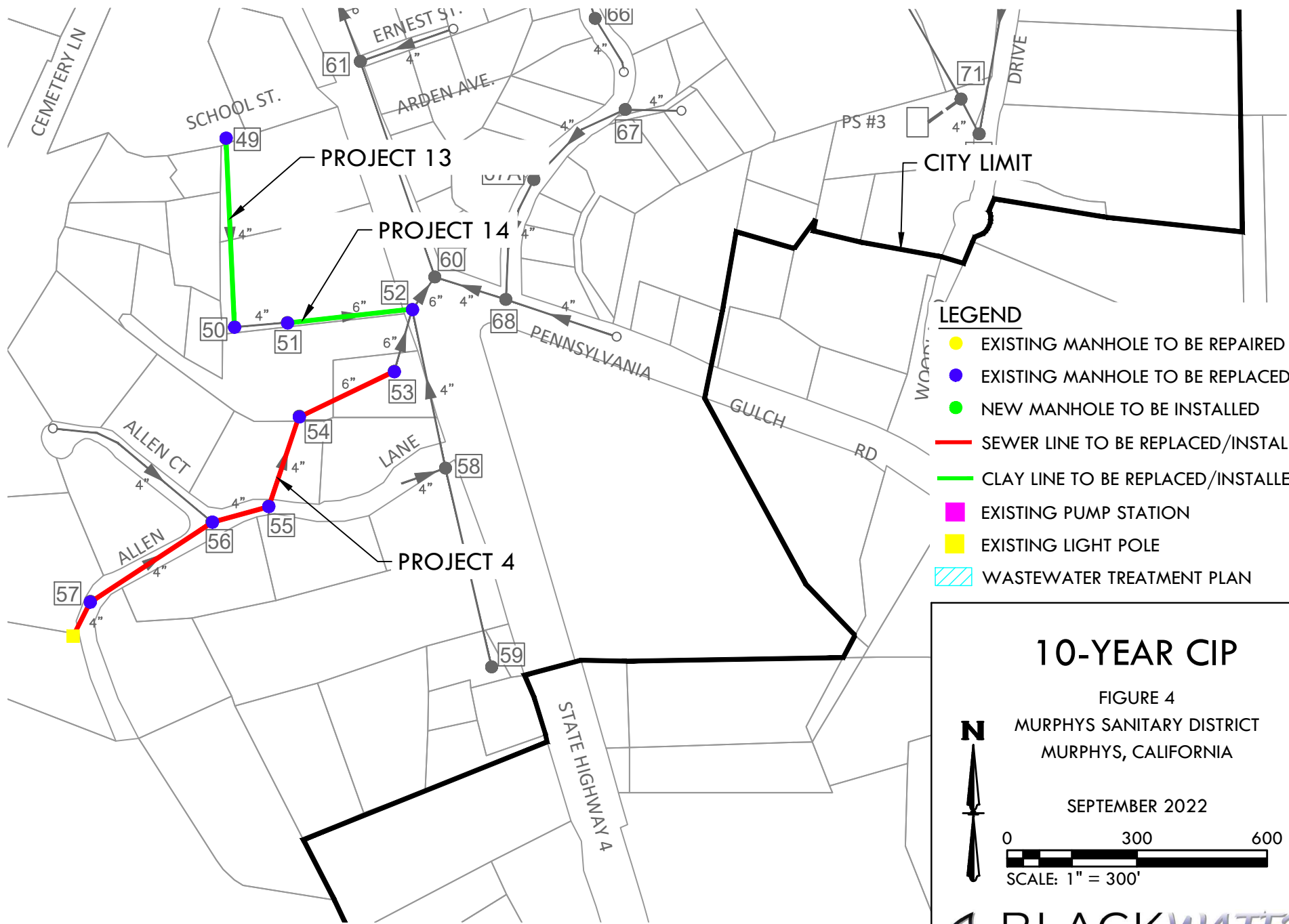

LEGEND

- EXISTING MANHOLE TO BE REPAIRED
- EXISTING MANHOLE TO BE REPLACED
- NEW MANHOLE TO BE INSTALLED
- SEWER LINE TO BE REPLACED/INSTALLED
- CLAY LINE TO BE REPLACED/INSTALLED
- EXISTING PUMP STATION
- EXISTING LIGHT POLE
- WASTEWATER TREATMENT PLAN

10-YEAR CIP

FIGURE 4
MURPHYS SANITARY DISTRICT
MURPHYS, CALIFORNIA

SEPTEMBER 2022

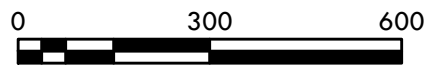

SCALE: 1" = 300'



BLACKWATER
CONSULTING ENGINEERS
602 LYELL DRIVE, MODESTO, CA 95356 • PH:209.322.1820

\\122388 ASD DISTRICT ENGINEER\CAD\TASK-01_22A-2021 BROCHURE\EXHIBITS\BROCHURES\888_10_YR_CIP\DWG PLOT_9/1/2022 10:01:34 AM BY PATRICK SCOTT

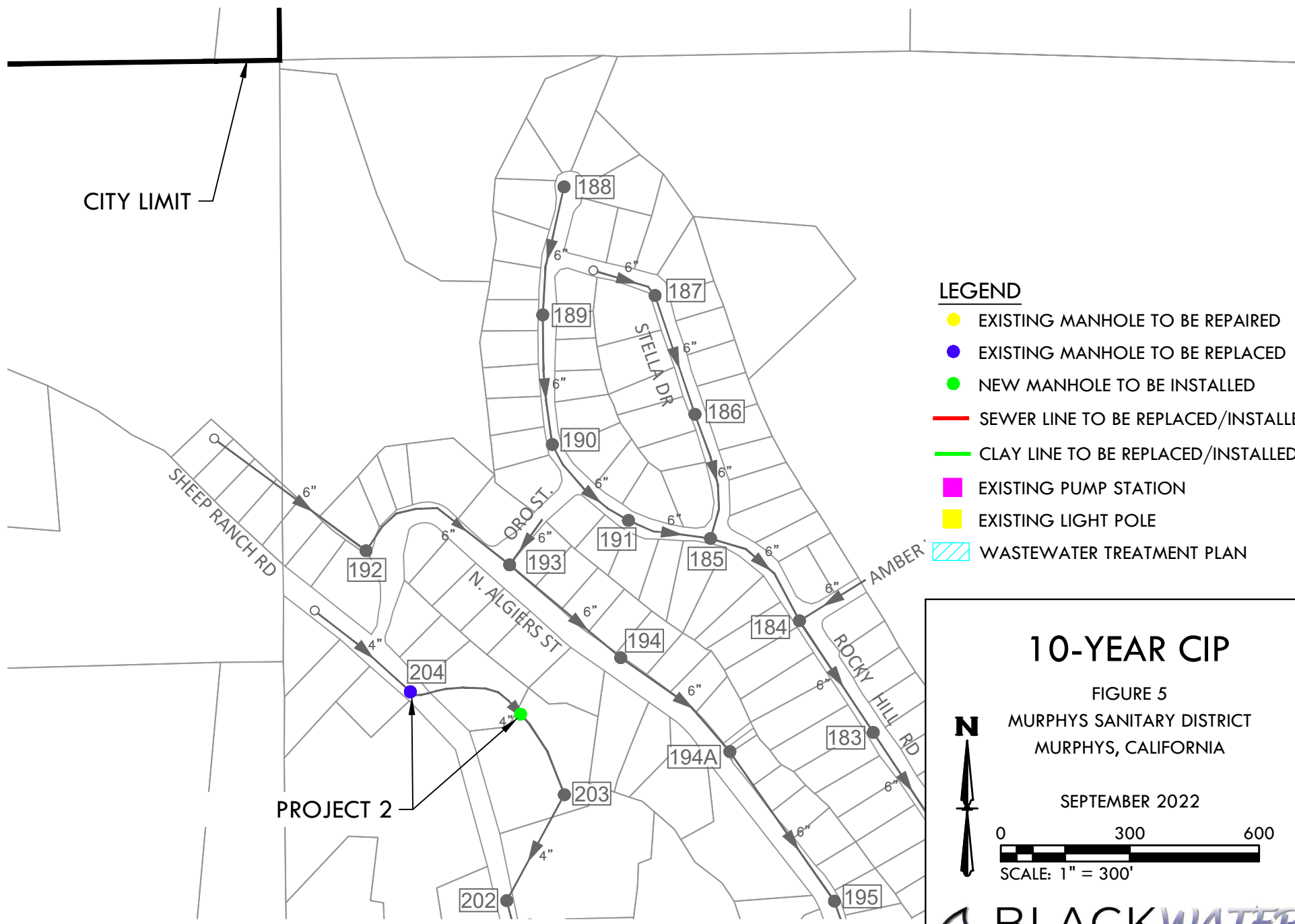

LEGEND

- EXISTING MANHOLE TO BE REPAIRED
- EXISTING MANHOLE TO BE REPLACED
- NEW MANHOLE TO BE INSTALLED
- SEWER LINE TO BE REPLACED/INSTALLED
- CLAY LINE TO BE REPLACED/INSTALLED
- EXISTING PUMP STATION
- EXISTING LIGHT POLE
- WASTEWATER TREATMENT PLAN

10-YEAR CIP

FIGURE 5
MURPHYS SANITARY DISTRICT
MURPHYS, CALIFORNIA

SEPTEMBER 2022

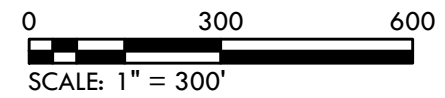

BLACKWATER
CONSULTING ENGINEERS
602 LYELL DRIVE, MODESTO, CA 95356 • PH:209.322.1820

\\122388 ASD DISTRICT ENGINEER\CAD\TASK-01_22A_2021 BROCHURE\EXHIBITS\BROCHURES\888_10_YR_CIP.DWG PLOT_9/1/2022 10:01:39 AM BY PATRICK SCOTT

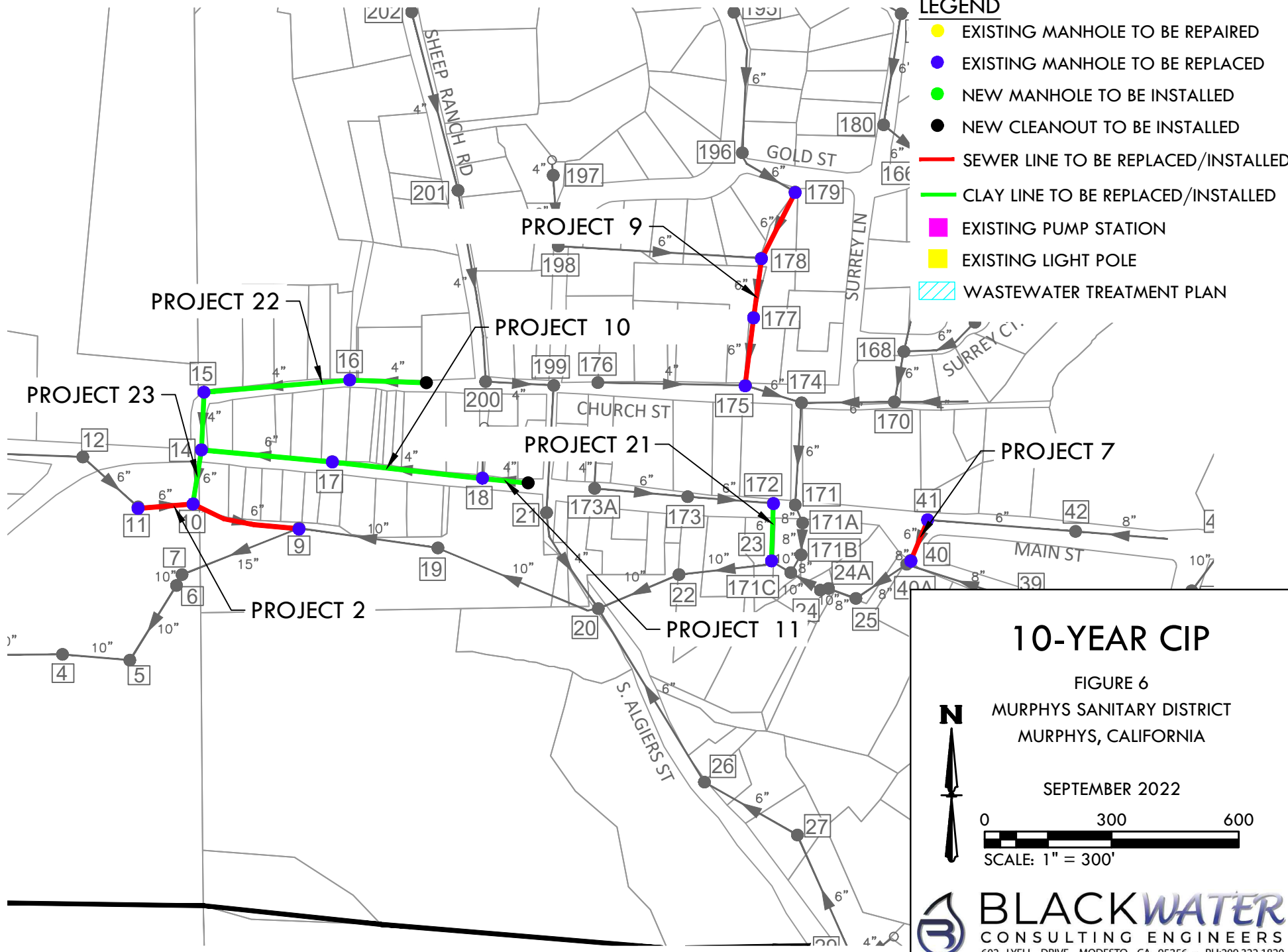

LEGEND

- EXISTING MANHOLE TO BE REPAIRED
- EXISTING MANHOLE TO BE REPLACED
- NEW MANHOLE TO BE INSTALLED
- NEW CLEANOUT TO BE INSTALLED
- SEWER LINE TO BE REPLACED/INSTALLED
- CLAY LINE TO BE REPLACED/INSTALLED
- EXISTING PUMP STATION
- EXISTING LIGHT POLE
- WASTEWATER TREATMENT PLAN

10-YEAR CIP

FIGURE 6
MURPHYS SANITARY DISTRICT
MURPHYS, CALIFORNIA

SEPTEMBER 2022

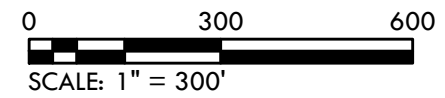

BLACKWATER
CONSULTING ENGINEERS
602 LYELL DRIVE, MODESTO, CA 95356 • PH:209.322.1820

\\122388 ASD DISTRICT ENGINEER\CAD\TASK-01_22A_2021 BROCHURE\EXHIBITS\BROCHURES\888_10_YR_CIP.DWG PLOT: 9/1/2022 10:01:44 AM BY PATRICK SCOTT

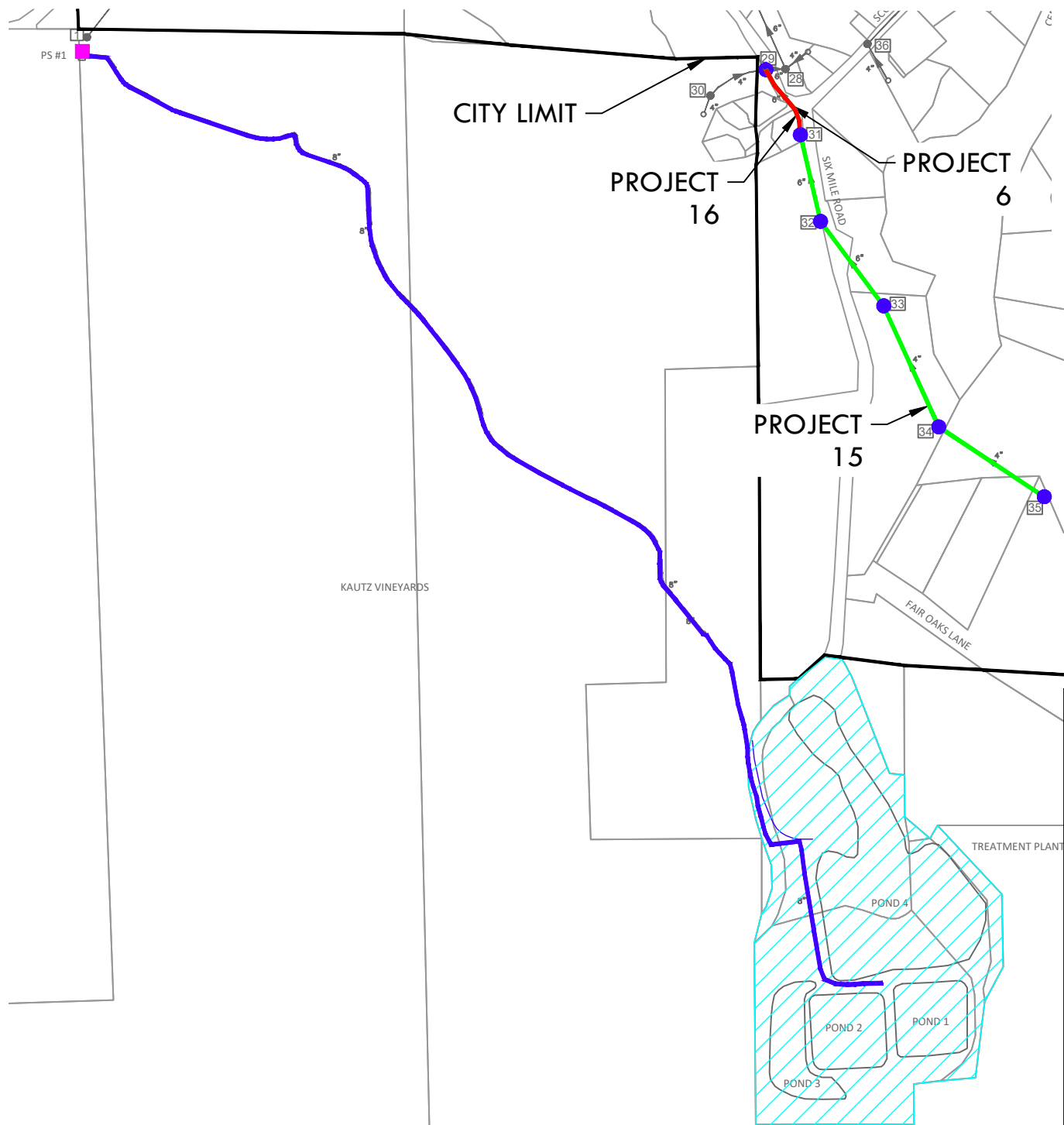

LEGEND

- EXISTING MANHOLE TO BE REPAIRED
- EXISTING MANHOLE TO BE REPLACED
- NEW MANHOLE TO BE INSTALLED
- EXISTING FORCE MAIN
- SEWER LINE TO BE REPLACED/INSTALLED
- CLAY LINE TO BE REPLACED/INSTALLED
- EXISTING PUMP STATION
- EXISTING LIGHT POLE
- WASTEWATER TREATMENT PLAN
-

10-YEAR CIP

FIGURE 7
 MURPHYS SANITARY DISTRICT
 MURPHYS, CALIFORNIA

SEPTEMBER 2022

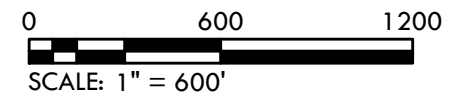

BLACKWATER
 CONSULTING ENGINEERS
 602 LYELL DRIVE, MODESTO, CA 95356 • PH:209.322.1820